

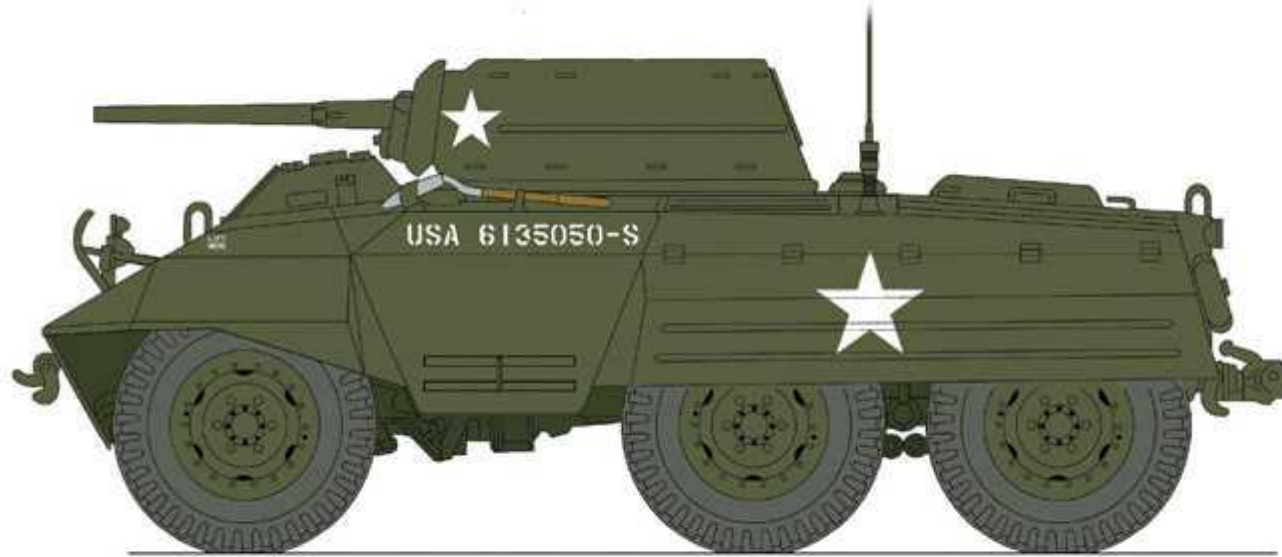



A. U.S. Army, 2nd Cavalry Group, 42nd Cavalry Rec. Squadron, HQ Company, Brehal, France, 31 July 1944.



 Flat Olive Drab U.S. Army 4728AP F.S. 34084	 Flat Rubber 4861AP F.S. 26081	 Flat Wood 4673AP F.S. 17043	 Met. Flat Gun Metal 4681AP F.S. 37200
--	--	---	--

B. U.S. Army, 2nd Arm. Division, 82nd Armored Recon. Batt., C Company, France, 1944.

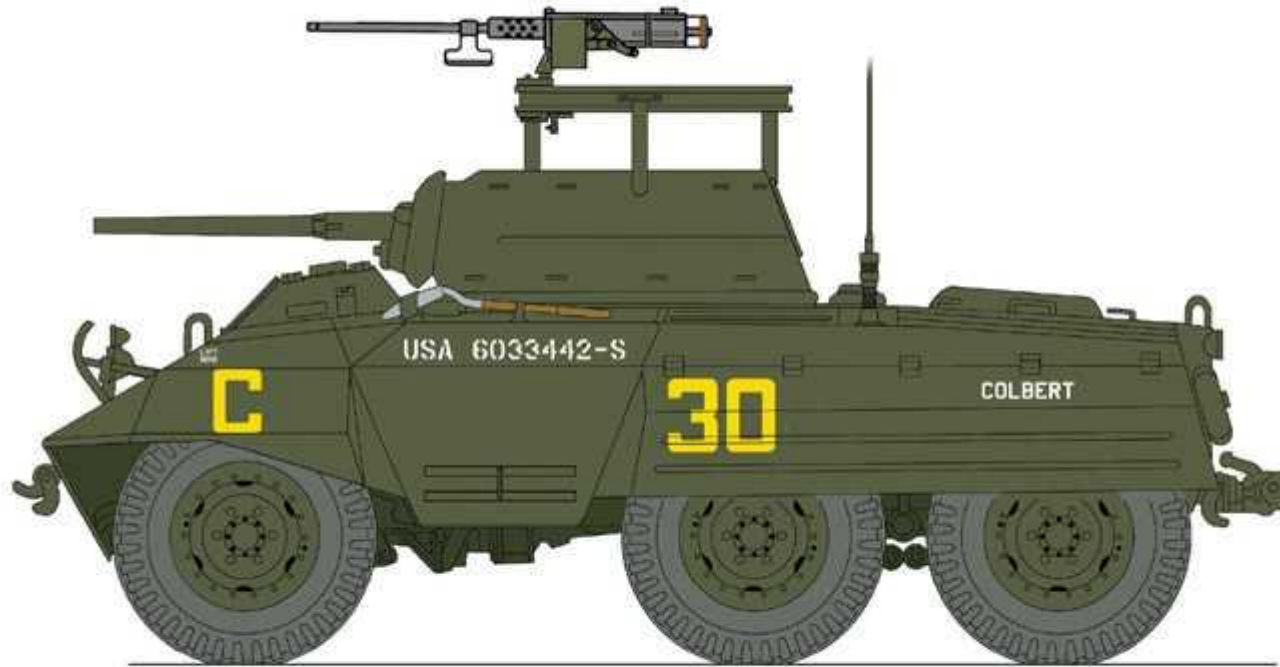

Flat Olive Drab U.S. Army
4728AP
F.S. 34084

Flat Rubber
4861AP
F.S. 26081

Flat Wood
4673AP
F.S. 17043

Met. Flat Gun Metal
4681AP
F.S. 37200

C. U.S. Army, 14th Cavalry Group, 18th Cavalry Rec. Sq., C company, Poteau, December 1944.



Flat Olive Drab U.S. Army
4728AP
F.S. 34084

Flat Rubber
4861AP
F.S. 26081

Flat Wood
4673AP
F.S. 17043

Met. Flat Gun Metal
4681AP
F.S. 37200

D. *Brazilian Exped. Force, 1st Infantry Division, 1st Recon. Sq., Montese, Italy, april 1945.*



 **Flat Olive Drab U.S. Army**
4728AP
F.S. 34084

 **Flat Rubber**
4861AP
F.S. 26081

 **Flat Wood**
4673AP
F.S. 17043

 **Met. Flat Gun Metal**
4681AP
F.S. 37200

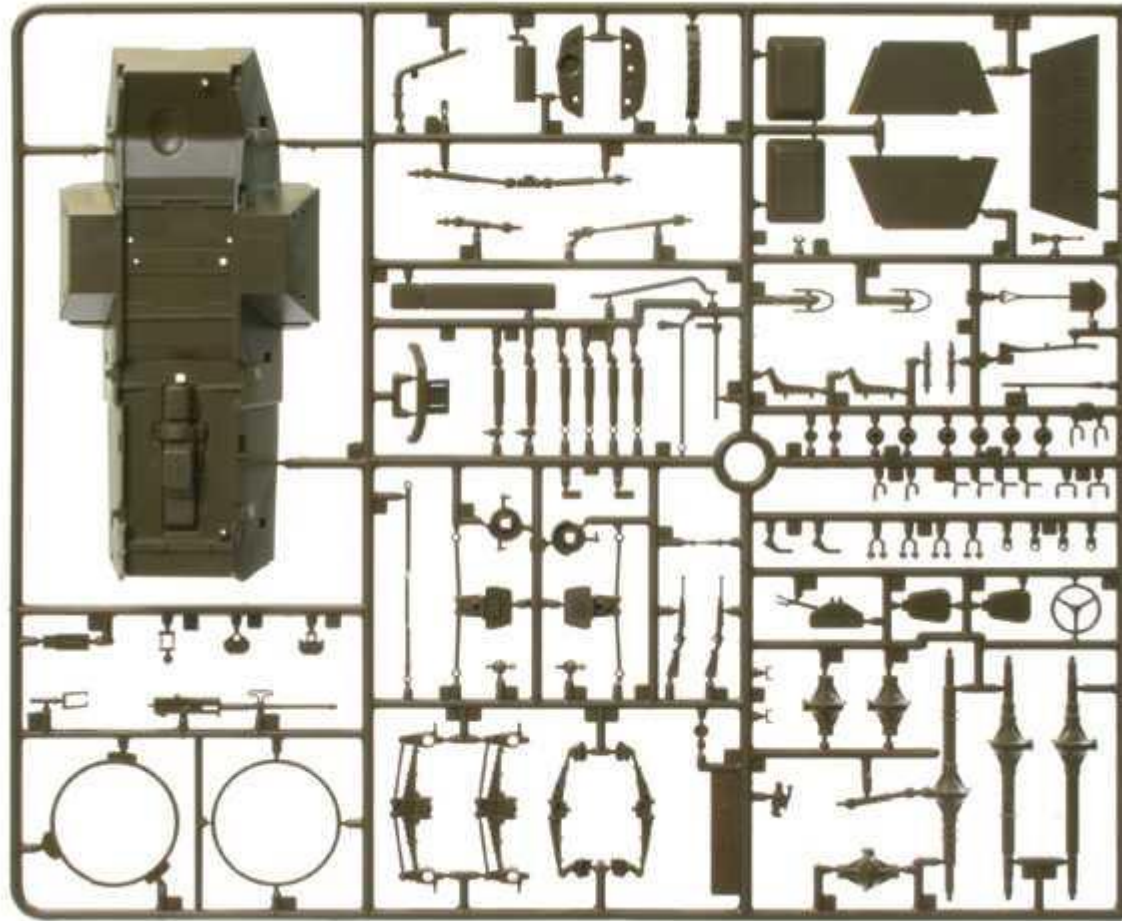

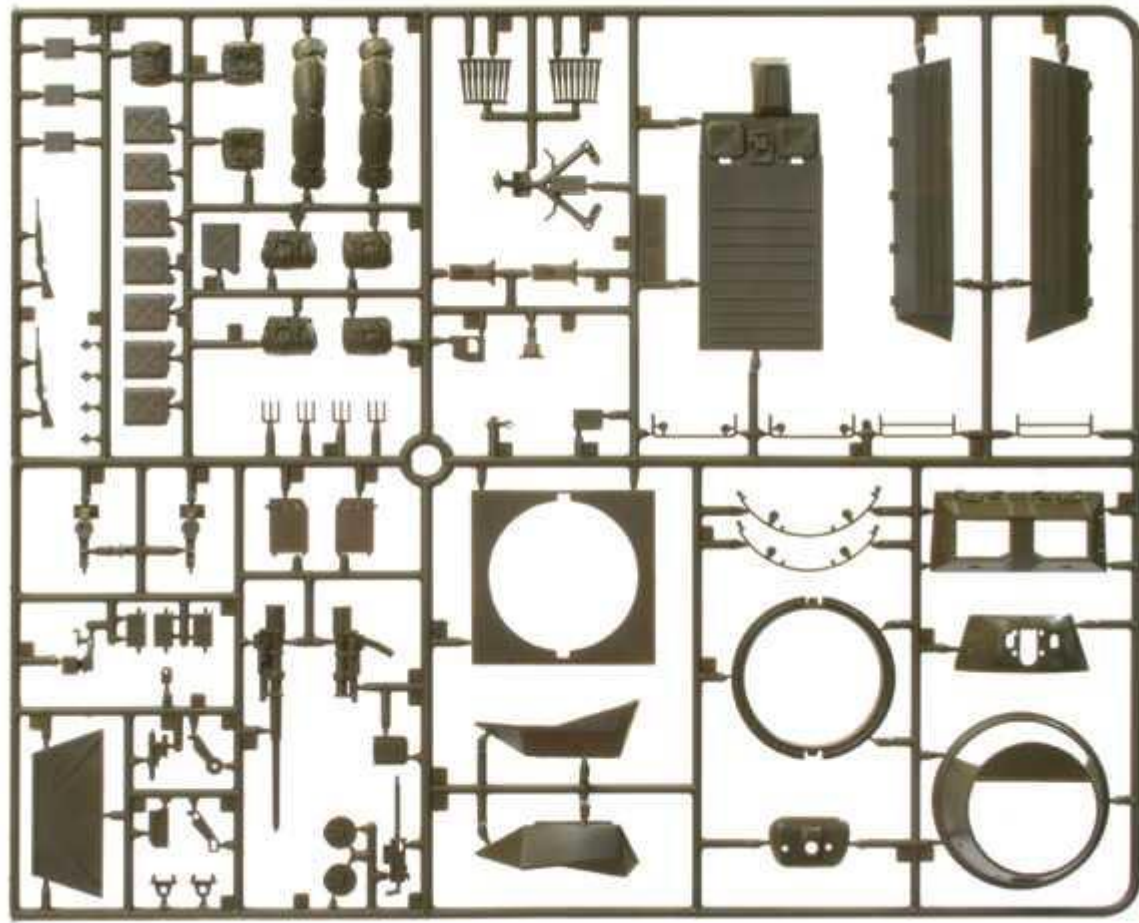

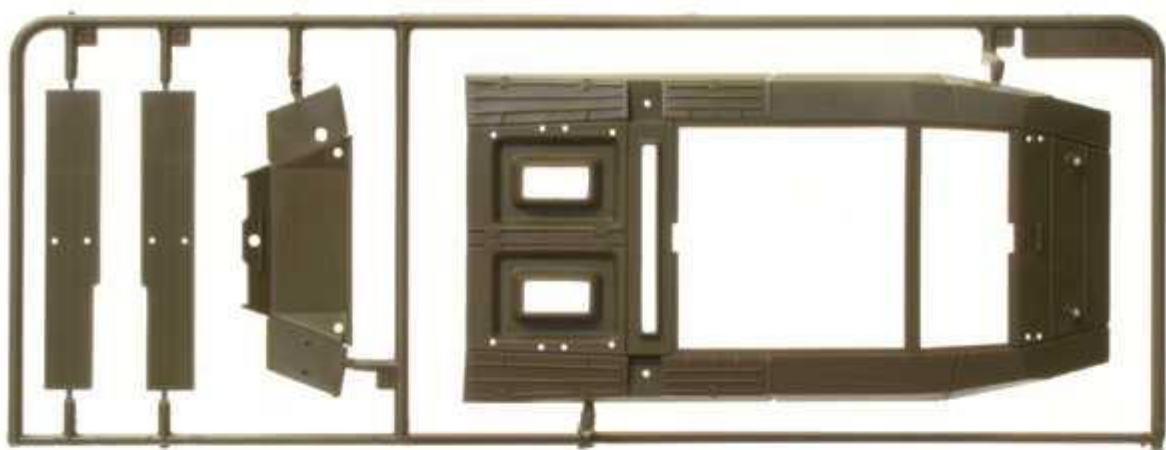

COMMON PARTS



<p>A</p> <p>1 USA 6135050-5 HQ-22 42CR-2C 4 </p> <p>2 USA 6135050-5 HQ-22 42CR-2C 5 </p>	<p>C</p> <p>1 USA 6037104 5 </p> <p>2 IA-18C 3 C-2 4 IA 6</p> <p>IA-18C C-2 IA</p>
<p>B</p> <p>1 </p> <p>2 USA 6033442-5 30</p> <p>USA 6033442-5 4 30</p> <p>COLBERT 3 COLBERT</p> <p>5 2Δ-82C C-C- 7 C-30</p> <p>2Δ-82C 6 C-30</p>	<p>D</p> <p>1 </p> <p>2 </p> <p>3 </p> <p>4 </p> <p>5 </p> <p>6 VIRA MUNDO 7 FEB 510 6 6</p> <p>VIRA MUNDO FEB 510</p>